

Retro-fit with Flush Fin frame

580 Single Hung Flush Fin Illustrated

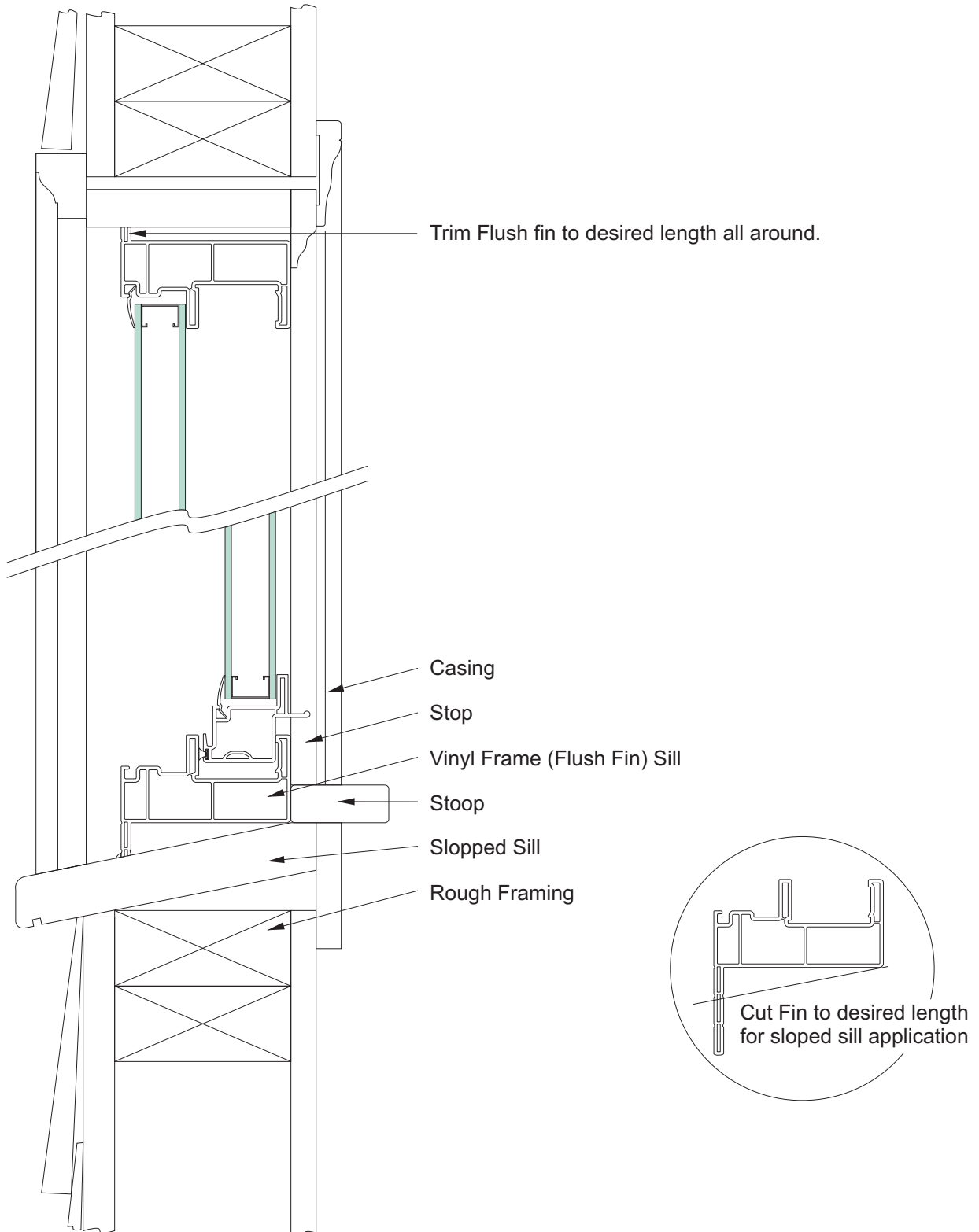

Retro-fit Installations

Realizing that building structures and conditions will vary, it is acceptable and sometimes unavoidable that installation procedures will be different. The image below illustrates one common method as an acceptable modified installation where the fastener is located through the frame as opposed to through the nailing flange, or with the nailing flange removed.

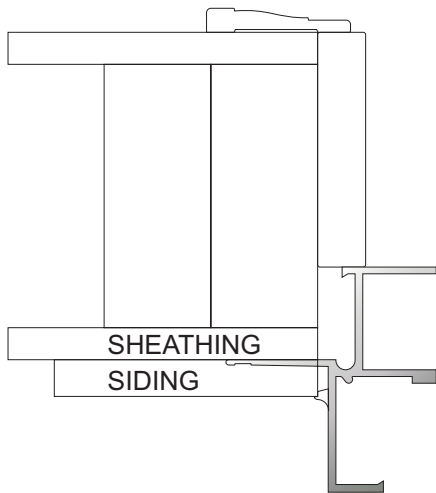

(EXISTING ALUMINUM WINDOW APPLICATION)

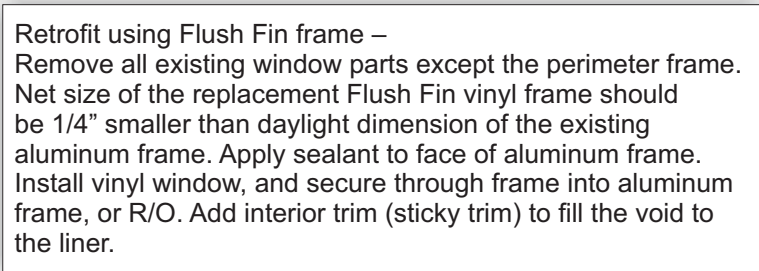
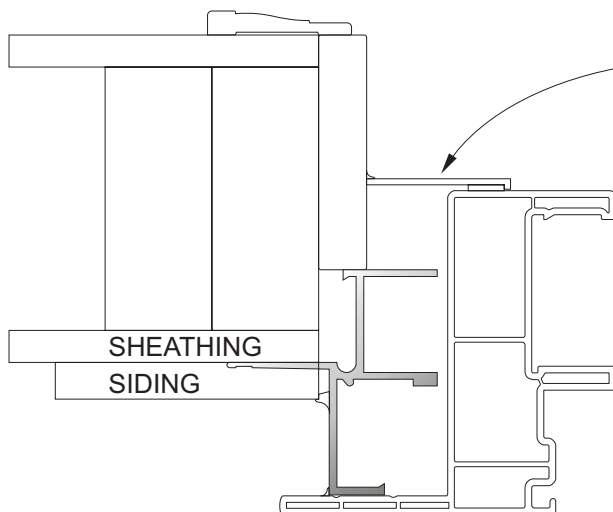
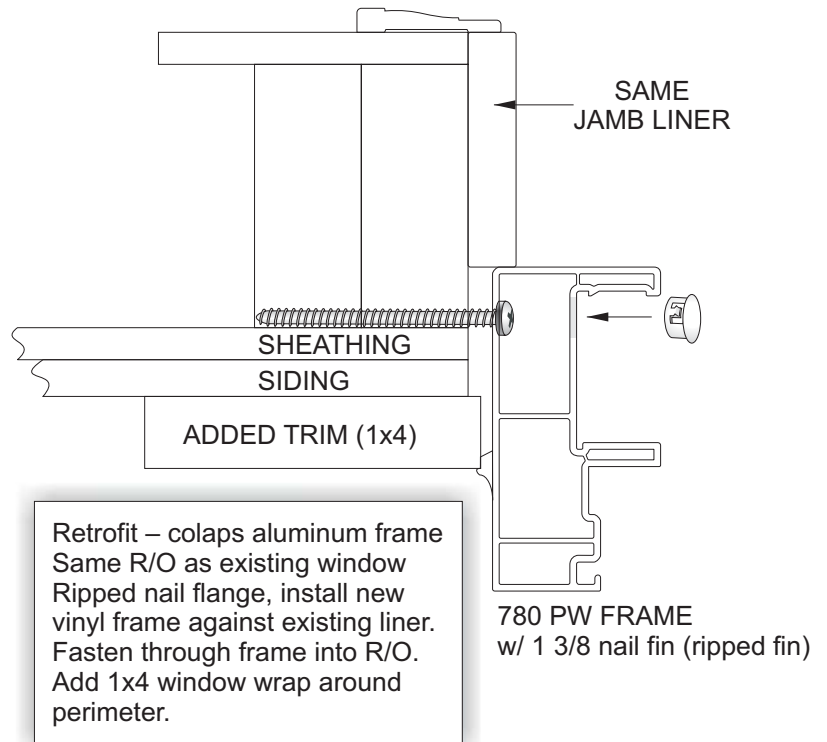

As with all products manufactured by Alside and installed by others, it is ultimately the installers responsibility to insure that a water tight condition is made between the window and the weather barrier system of the wall.